

## G ELECTRICAL WIRING ROUTING

### Position of Parts in Engine Compartment

[1ZZ-FE]

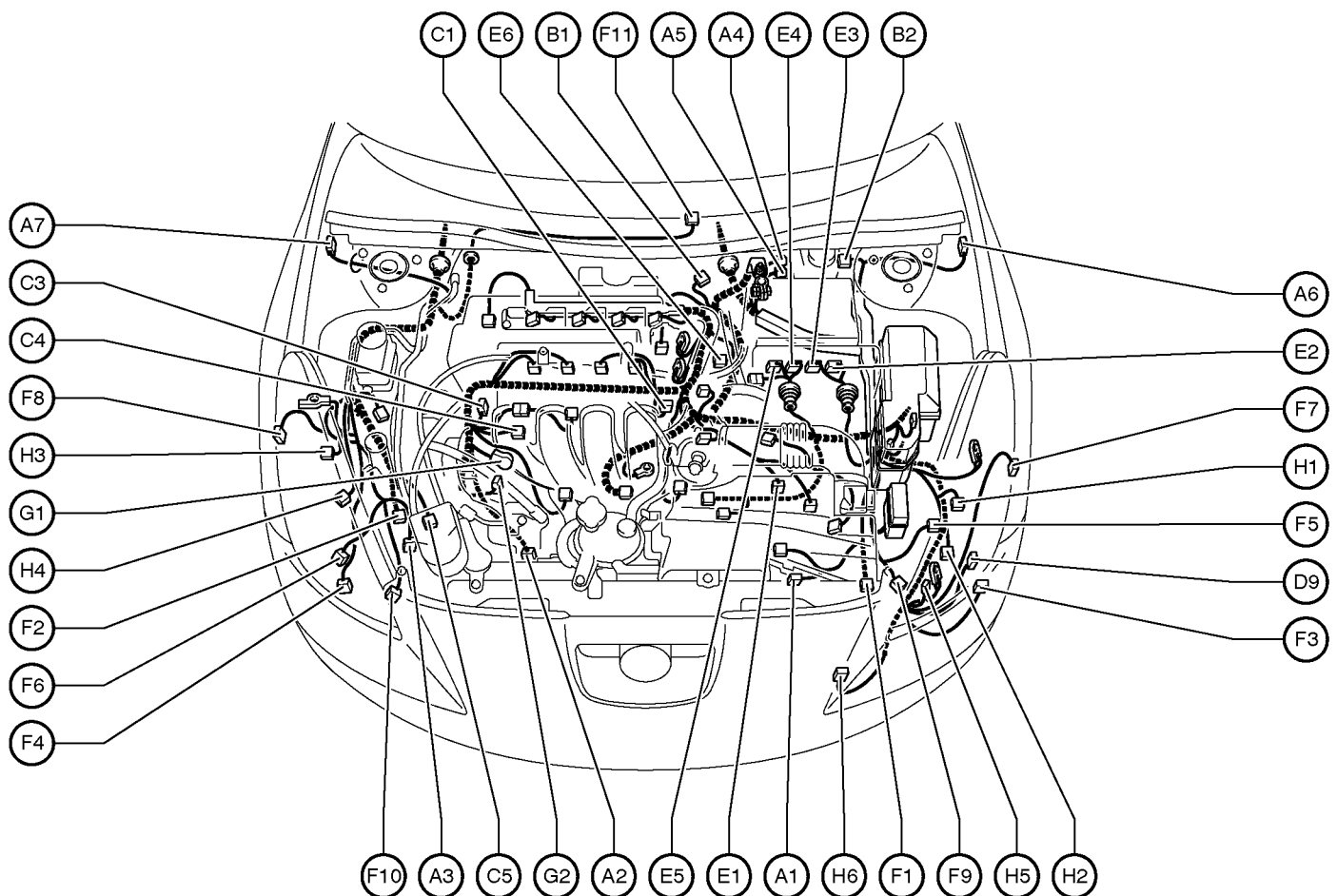

- A 1 A/C Condenser Fan Motor
- A 2 A/C Magnetic Clutch and Lock Sensor
- A 3 A/C Triple Pressure SW  
(A/C Dual and Single Pressure SW)
- A 4 ABS Actuator
- A 5 ABS Actuator
- A 6 ABS Speed Sensor Front LH
- A 7 ABS Speed Sensor Front RH

- B 1 Back-Up Light SW
- B 2 Brake Fluid Level Warning SW

- C 1 Camshaft Position Sensor
- C 3 Camshaft Timing Oil Control Valve (VVT)
- C 4 Crankshaft Position Sensor
- C 5 Cruise Control Actuator

- D 9 Daytime Running Light Resistor

- E 1 Electronically Controlled Transmission Solenoid
- E 2 Engine Control Module
- E 3 Engine Control Module
- E 4 Engine Control Module
- E 5 Engine Control Module
- E 6 Engine Coolant Temp. Sensor

- F 1 Front Airbag Sensor LH
- F 2 Front Airbag Sensor RH
- F 3 Front Fog Light LH
- F 4 Front Fog Light RH
- F 5 Front Parking Light LH
- F 6 Front Parking Light RH
- F 7 Front Side Marker Light LH
- F 8 Front Side Marker Light RH
- F 9 Front Turn Signal Light LH
- F 10 Front Turn Signal Light RH
- F 11 Front Wiper Motor

- G 1 Generator
- G 2 Generator

- H 1 Headlight LH (High)
- H 2 Headlight LH (Low)
- H 3 Headlight RH (High)
- H 4 Headlight RH (Low)
- H 5 Horn LH
- H 6 Horn RH

## Position of Parts in Engine Compartment

**[1ZZ-FE]**

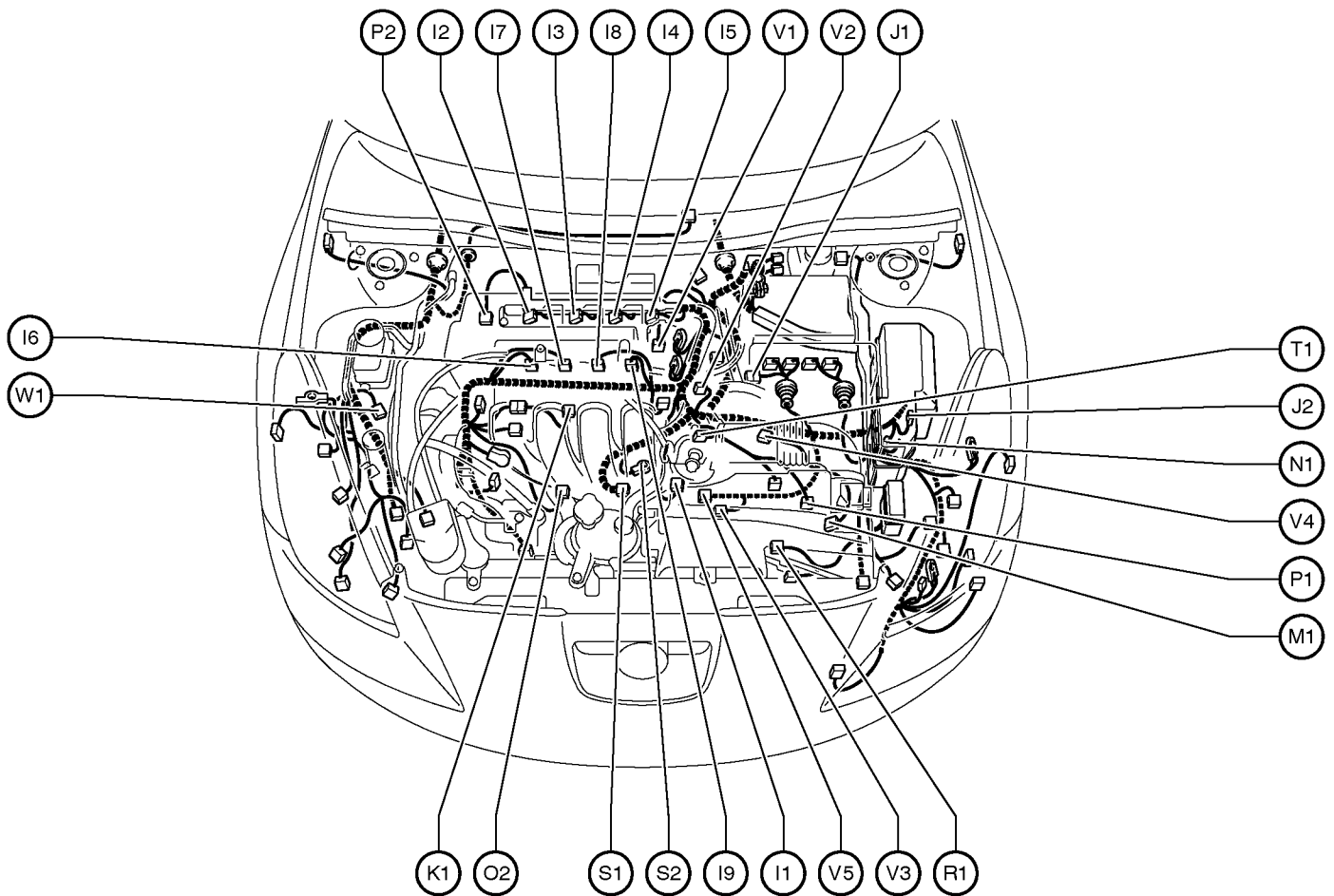

I 1 Idle Air Control Valve  
 I 2 Ignition Coil and Igniter No.1  
 I 3 Ignition Coil and Igniter No.2  
 I 4 Ignition Coil and Igniter No.3  
 I 5 Ignition Coil and Igniter No.4  
 I 6 Injector No.1  
 I 7 Injector No.2  
 I 8 Injector No.3  
 I 9 Injector No.4

J 1 Junction Connector  
 J 2 Junction Connector

K 1 Knock Sensor

M 1 Mass Air Flow Meter

N 1 Noise Filter (Ignition System)

O 2 Oil Pressure SW

P 1 Park/Neutral Position SW  
 P 2 Power Steering Oil Pressure SW

R 1 Radiator Fan Motor

S 1 Starter  
 S 2 Starter

T 1 Throttle Position Sensor

V 1 Vehicle Speed Sensor (Combination Meter)  
 V 2 Vehicle Speed Sensor  
 (Electronically Controlled Transmission)  
 V 3 VSV (ACIS)  
 V 4 VSV (Canister Closed Valve)  
 V 5 VSV (EVAP)

W 1 Washer Motor

## G ELECTRICAL WIRING ROUTING

### Position of Parts in Engine Compartment

[2ZZ-GE]

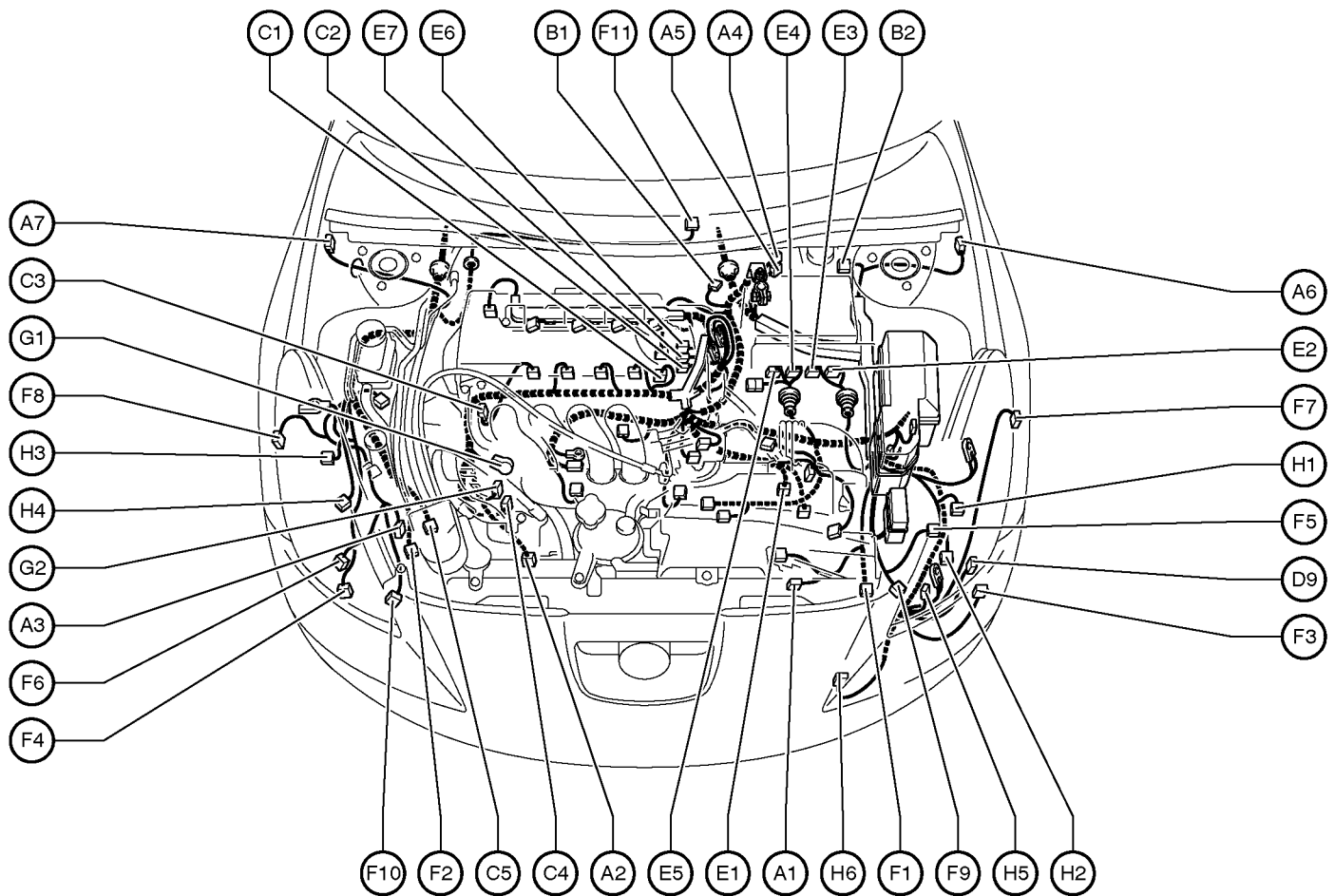

- A 1 A/C Condenser Fan Motor
- A 2 A/C Magnetic Clutch and Lock Sensor
- A 3 A/C Triple Pressure SW  
(A/C Dual and Single Pressure SW)
- A 4 ABS Actuator
- A 5 ABS Actuator
- A 6 ABS Speed Sensor Front LH
- A 7 ABS Speed Sensor Front RH

- B 1 Back-Up Light SW
- B 2 Brake Fluid Level Warning SW

- C 1 Camshaft Position Sensor
- C 2 Camshaft Timing Oil Control Valve (VVL)
- C 3 Camshaft Timing Oil Control Valve (VVT)
- C 4 Crankshaft Position Sensor
- C 5 Cruise Control Actuator

- D 9 Daytime Running Light Resistor

- E 1 Electronically Controlled Transmission Solenoid
- E 2 Engine Control Module
- E 3 Engine Control Module
- E 4 Engine Control Module
- E 5 Engine Control Module
- E 6 Engine Coolant Temp. Sensor
- E 7 Oil Pressure SW (VVTL)

- F 1 Front Airbag Sensor LH
- F 2 Front Airbag Sensor RH
- F 3 Front Fog Light LH
- F 4 Front Fog Light RH
- F 5 Front Parking Light LH
- F 6 Front Parking Light RH
- F 7 Front Side Marker Light LH
- F 8 Front Side Marker Light RH
- F 9 Front Turn Signal Light LH
- F 10 Front Turn Signal Light RH
- F 11 Front Wiper Motor

- G 1 Generator
- G 2 Generator

- H 1 Headlight LH (High)
- H 2 Headlight LH (Low)
- H 3 Headlight RH (High)
- H 4 Headlight RH (Low)
- H 5 Horn (High)
- H 6 Horn (Low)

## Position of Parts in Engine Compartment

[2ZZ-GE]

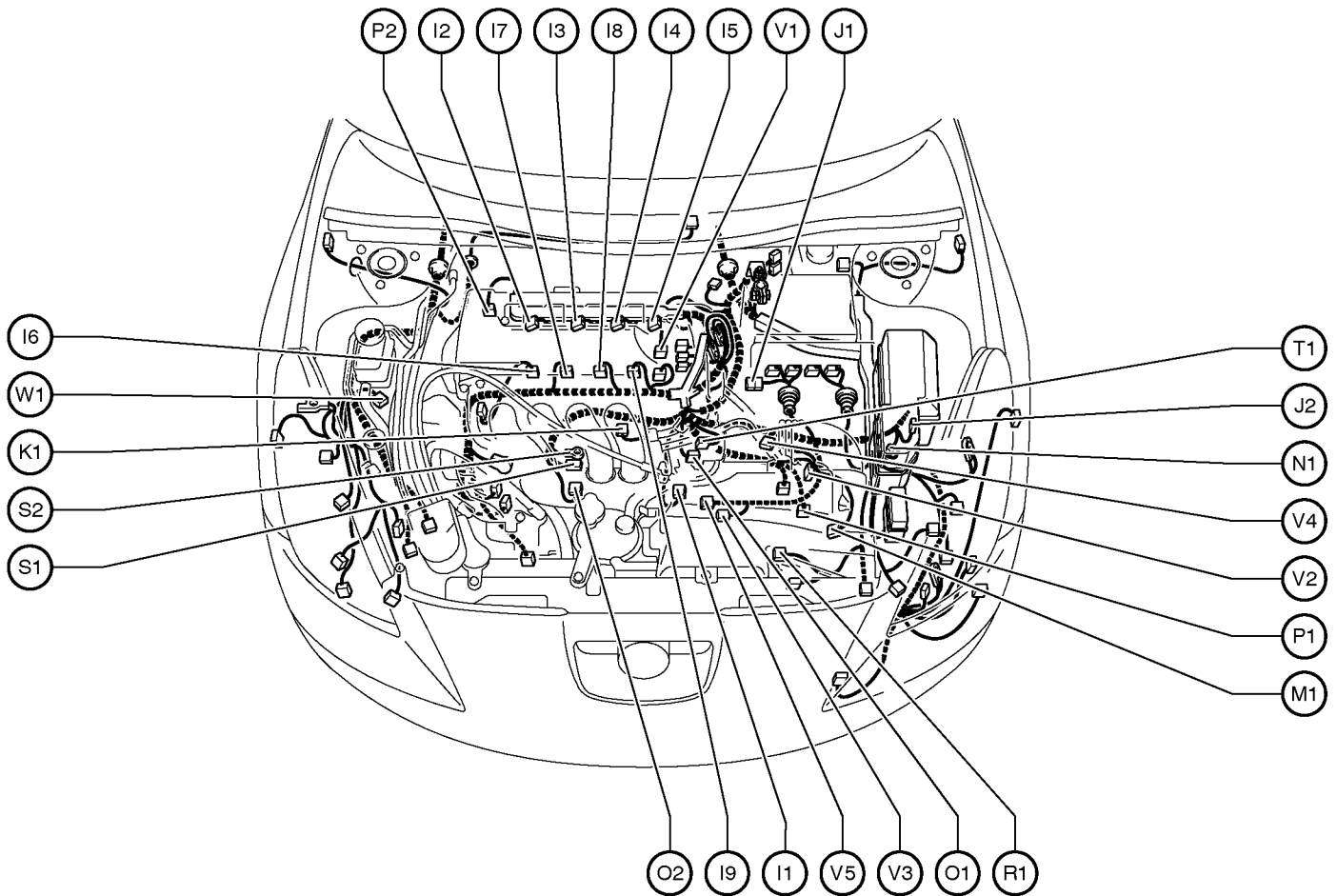

- I 1 Idle Air Control Valve
- I 2 Ignition Coil and Igniter No.1
- I 3 Ignition Coil and Igniter No.2
- I 4 Ignition Coil and Igniter No.3
- I 5 Ignition Coil and Igniter No.4
- I 6 Injector No.1
- I 7 Injector No.2
- I 8 Injector No.3
- I 9 Injector No.4

- J 1 Junction Connector
- J 2 Junction Connector

- K 1 Knock Sensor

- M 1 Mass Air Flow Meter

- N 1 Noise Filter (Ignition System)

- O 1 O/D Direct Clutch Speed Sensor
- O 2 Oil Pressure SW

- P 1 Park/Neutral Position SW
- P 2 Power Steering Oil Pressure SW

- R 1 Radiator Fan Motor

- S 1 Starter
- S 2 Starter

- T 1 Throttle Position Sensor

- V 1 Vehicle Speed Sensor (Combination Meter)
- V 2 Vehicle Speed Sensor  
(Electronically Controlled Transmission)
- V 3 VSV (ACIS)
- V 4 VSV (Canister Closed Valve)
- V 5 VSV (EVAP)

- W 1 Washer Motor

## G ELECTRICAL WIRING ROUTING

### Position of Parts in Instrument Panel

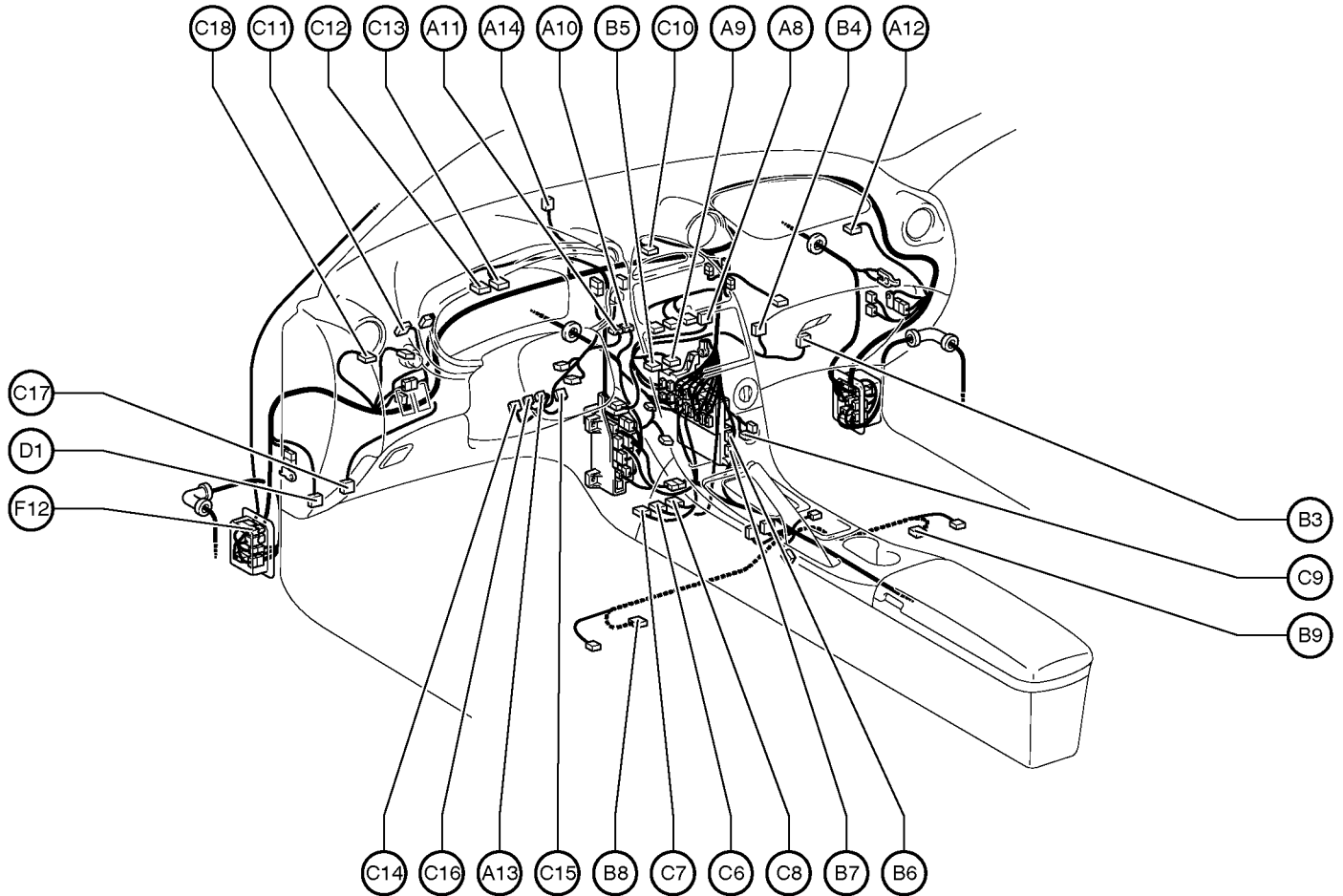

A 8 A/C Evaporator Temp. Sensor  
 A 9 A/C SW  
 A10 ABS ECU  
 A11 ABS ECU  
 A12 Airbag Squib (Front Passenger Airbag Assembly)  
 A13 Airbag Squib (Steering Wheel Pad)  
 A14 Automatic Light Control Sensor

B 3 Blower Motor  
 B 4 Blower Resistor  
 B 5 Blower SW  
 B 6 Body ECU  
 B 7 Body ECU  
 B 8 Buckle SW LH  
 B 9 Buckle SW RH

C 6 Center Airbag Sensor Assembly  
 C 7 Center Airbag Sensor Assembly  
 C 8 Center Airbag Sensor Assembly  
 C 9 Cigarette Lighter  
 C10 Clock  
 C11 Clutch Start SW  
 C12 Combination Meter  
 C13 Combination Meter  
 C14 Combination SW  
 C15 Combination SW  
 C16 Combination SW  
 C17 Cruise Control Clutch SW  
 C18 Cruise Control ECU

D 1 Data Link Connector 3

F 12 Front Fog Light Relay

## Position of Parts in Instrument Panel

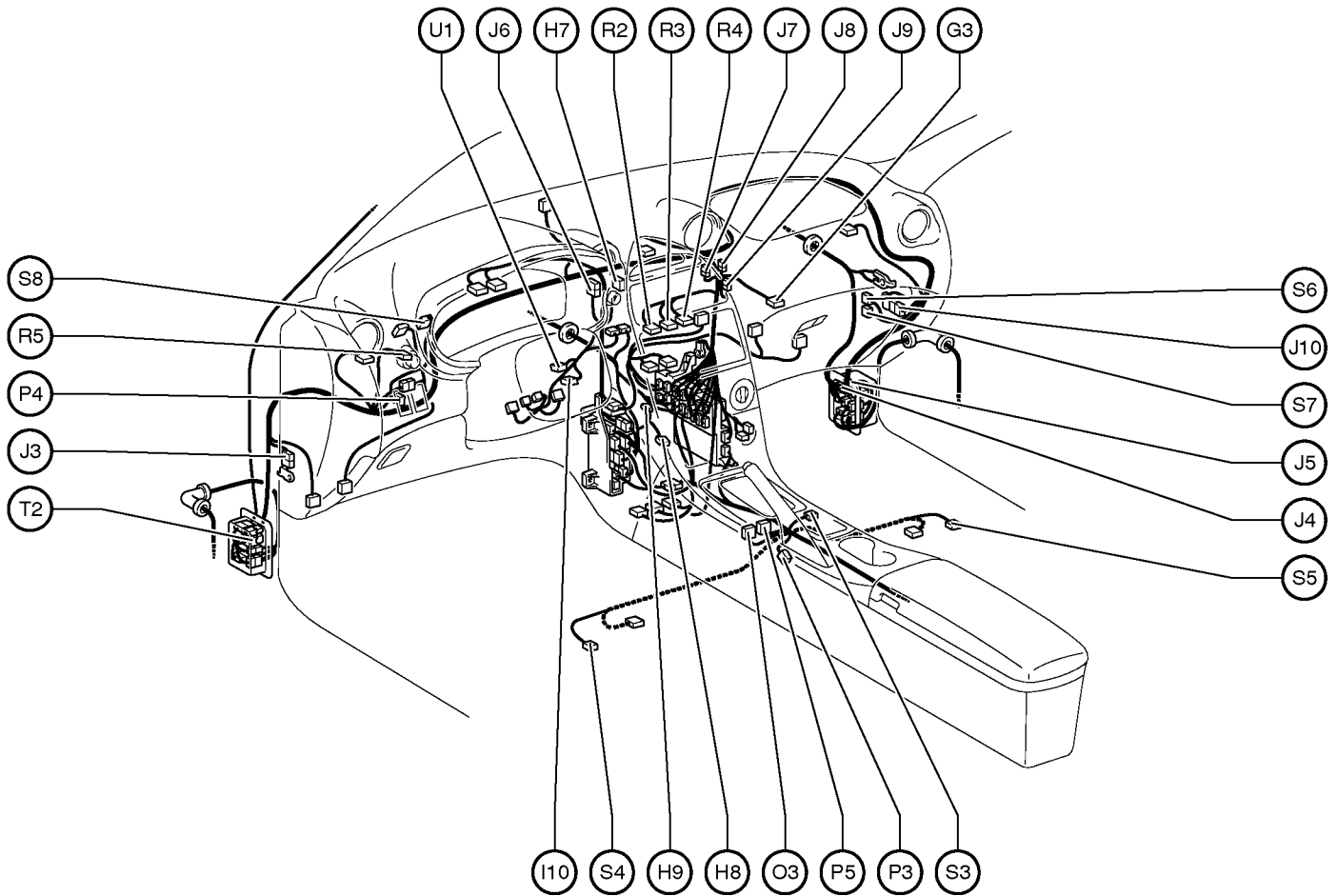

G 3 Glove Box Light and SW

H 7 Hazard SW

H 8 Heated Oxygen Sensor (Bank 1 Sensor 1)

H 9 Heated Oxygen Sensor (Bank 1 Sensor 2)

I 10 Ignition SW

J 3 Junction Connector

J 4 Junction Connector

J 5 Junction Connector

J 6 Junction Connector

J 7 Junction Connector

J 8 Junction Connector

J 9 Junction Connector

J 10 Junction Connector

O 3 O/D Main SW

P 3 Parking Brake SW

P 4 Power Window Lock SW

P 5 Power Window Master SW

R 2 Radio and Player

R 3 Radio and Player

R 4 Radio and Player

R 5 Rheostat

S 3 Shift Lock Control ECU

S 4 Side Airbag Squib LH

S 5 Side Airbag Squib RH

S 6 Stereo Component Amplifier

S 7 Stereo Component Amplifier

S 8 Stop Light SW

T 2 Turn Signal Flasher Relay

U 1 Unlock Warning SW

## G ELECTRICAL WIRING ROUTING

## Position of Parts in Body

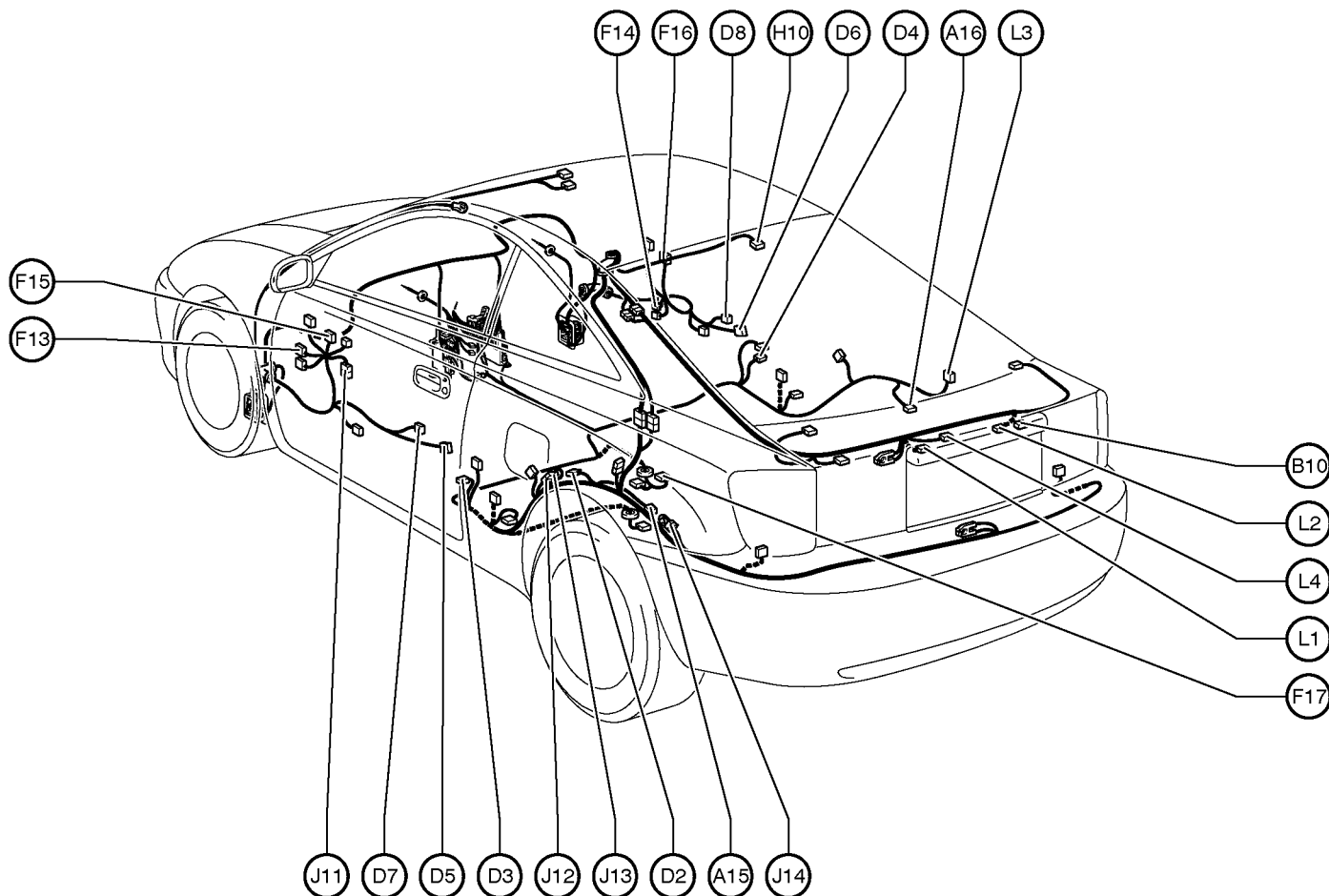

A15 ABS Speed Sensor Rear LH  
A16 ABS Speed Sensor Rear RH

## B10 Back Door Lock Motor

- D 2 Door Control Receiver
- D 3 Door Courtesy SW LH
- D 4 Door Courtesy SW RH
- D 5 Door Lock Motor,Door Lock Detection SW and  
Door Key Lock and Unlock SW LH
- D 6 Door Lock Motor,Door Lock Detection SW and  
Door Key Lock and Unlock SW RH
- D 7 Door Side Airbag Sensor LH
- D 8 Door Side Airbag Sensor RH

F 13 Front Door Speaker LH  
F 14 Front Door Speaker RH  
F 15 Front Door Tweeter Speaker LH  
F 16 Front Door Tweeter Speaker RH  
F 17 Fuel Sender and Pump

## H10 High Mounted Stop Light

J 11 Junction Connector  
J 12 Junction Connector  
J 13 Junction Connector  
J 14 Junction Connector

- L 1 License Plate Light LH
- L 2 License Plate Light RH
- L 3 Luggage Compartment Light
- L 4 Luggage Compartment Light SW

## Position of Parts in Body

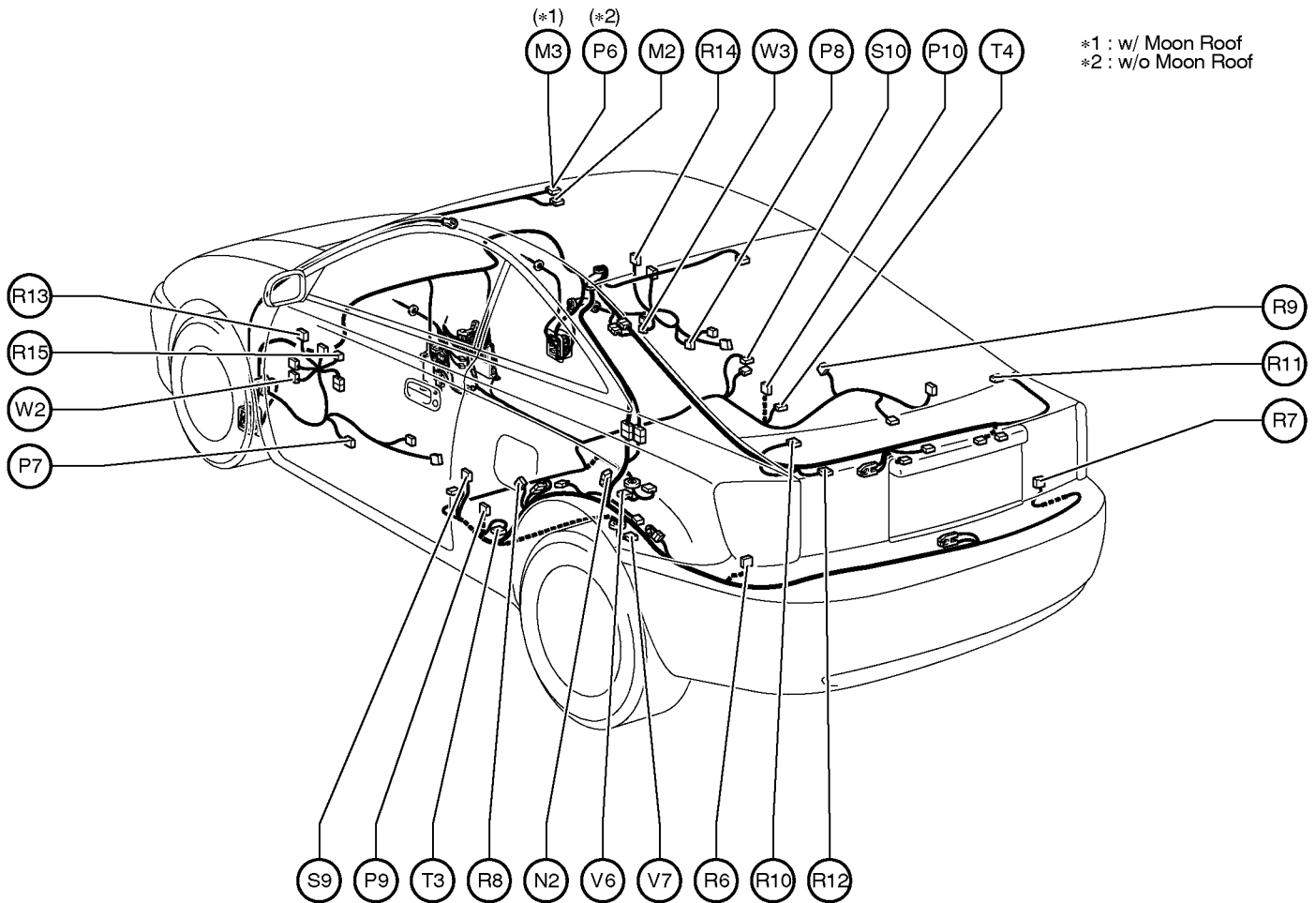

M 2 Moon Roof Control Relay and Motor  
M 3 Moon Roof Control SW and Personal Light

N 2 Noise Filter (Rear Window Defogger)

P 6 Personal Light (w/o Moon Roof)  
P 7 Power Window Motor LH  
P 8 Power Window Motor RH  
P 9 Pretensioner LH  
P10 Pretensioner RH

R 6 Rear Combination Light LH  
R 7 Rear Combination Light RH  
R 8 Rear Speaker LH  
R 9 Rear Speaker RH  
R10 Rear Window Defogger  
R11 Rear Window Defogger  
R12 Rear Wiper Motor and Relay  
R13 Remote Control Mirror LH  
R14 Remote Control Mirror RH  
R15 Remote Control Mirror SW

S 9 Side Airbag Sensor LH  
S10 Side Airbag Sensor RH

T 3 Tension Reducer Solenoid LH  
T 4 Tension Reducer Solenoid RH

V 6 Vapor Pressure Sensor  
V 7 VSV (Pressure Switching Valve)

W 2 Woofer Speaker LH  
W 3 Woofer Speaker RH